

# CONGA

## ROCKSTAR

**CONGA ROCKSTAR 9500 CONNECTED ERGOWET 3000 IA**

Aspirador vertical / Upright vacuum cleaner

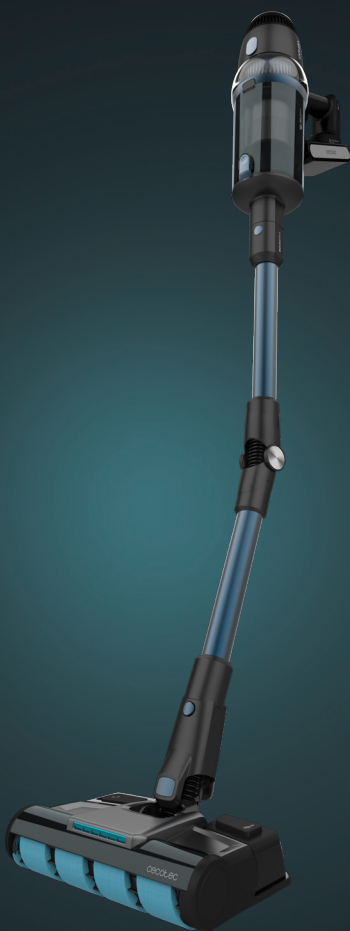

cecotec

Manual de instrucciones  
Instruction manual  
Manuel d'instructions  
Bedienungsanleitung  
Manuale di istruzioni  
Manual de instruções  
Handleiding  
Instrukcja obsługi  
Návod k použití

## 1. PARTS AND COMPONENTS

Fig. 1

1. Vacuuming-brush-head release button
2. Vacuuming-tube button
3. Dust tank bottom-cover unlock button
4. Dust-tank opening button and filter access
5. Vacuuming brush head
6. On/Off button
7. Power adapter
8. Charging base
9. Jalisco brush
10. 2-in-1 narrow accessory for corners and furniture
11. 2-in-1 wide accessory for corners and furniture
12. Motorised Upholstery Brush
13. Union elbow
14. Long brush
15. Extensible tube
16. Flexible vacuuming tube
17. Water tank
18. Special brush for fabrics

Fig. 2

1. Display
2. Speed dial
3. On/Off button
4. Battery
5. Battery release button

### PLEASE NOTE:

The graphics in this manual are schematic representations and may not exactly match the product.

## 2. BEFORE USE

- This upright vacuum cleaner includes a package designed to protect it during transport. Take the product out of the box and remove all packaging materials. Keep the original box and other elements in a safe place, as this will help you prevent product damage when

transporting it in the future. In case the original packaging is disposed of, make sure all packaging materials are recycled accordingly.

- Make sure all parts and components are included and in good conditions. If there is any piece missing or not in good condition, immediately contact the Technical Support Service of Cecotec.
- Fully charge the device before the first use.
- Remove the first-use tab installed in the filter.
- During the first 3 uses, it is recommended to charge the device for 12 hours between uses.
- The normal charge time is 6 hours approx. When the battery is fully charged, unplug it.

#### Box contents

- Conga Rockstar 3000 Advance ErgoWet Connected IA
- 2-in-1 narrow accessory for corners and furniture
- 2-in-1 wide accessory for corners and furniture
- Jalisco brush
- Motorised brush for upholstery
- Long brush
- Special brush for fabrics
- Union elbow
- Flexible vacuuming tube
- Extensible tube
- Watertank accessory
- Charging base
- Instruction manual

### 3. PRODUCT ASSEMBLY

#### Vacuuming tube and brush head assembly

- To install the vacuuming brush head into the vacuuming tube, align both of them making sure the tab on the brush head matches the guides on the tube, and introduce one into the other until they are firmly fixed.
- To disassemble them, press the vacuuming-brush-head release button and pull from the vacuuming tube while you hold the vacuuming brush head.

#### Warning

When assembling these 2 parts, make sure the handle and the brush are facing the same direction.

#### Vacuuming tube, vacuuming brush head, and main body assembly

To complete the vacuum cleaner's installation, once the vacuuming brush head is mounted on the vacuuming tube, hold the tube vertically and insert it into the main body.

#### Battery assembly

Fig. 3

Introduce the battery in the slot located in the main body following the guides. Once it is introduced, it will click into place. Once inserted, check that it is secured in position.

To disassemble the battery, press the release button and remove the battery.

#### Warning

Remove the battery and store it in a safe, dry place if the device is not going to be used in a long period of time.

### 4. OPERATION

You can use this vacuum cleaner in two different manners:

- Handheld vacuum cleaner, attaching the accessories directly to the main body.
- Upright vacuum cleaner, using the vacuuming tube with the accessories assembled.

#### Using the vacuum cleaner

- Press the power button to turn the vacuum cleaner on or off.
- Press the speed dial repeatedly to select the device's operating speed: LOW, MED, HIGH, and AUTO. The device will turn on in LOW mode by default.
- If AUTO mode is selected, the vacuum cleaner will automatically adjust the suction power based on dust concentration and surface type.
- The AI function can be activated when selecting AUTO mode: the upright vacuum cleaner will automatically increase the suction power in the following circumstances:
  - A. When you stop the movement, e.g., in corners to clean them more thoroughly.
  - B. When you make three passes in a row.
  - C. When placing the vacuuming tube perpendicular to the floor.
- The AI-function icon  will light up when activated.
- When the battery shows a percentage equal to or less than 20% while running at high speed, the vacuum cleaner will start running at medium speed automatically to extend the battery life.
- If too many particles or fibres are vacuumed, or if you touch the brush by accident during operation, the rotary brush automatically stops spinning to prevent tangles and possible damage.

### Accessories

This device includes different accessories that allow cleaning different types of surfaces, objects, and dirt. Some of them are suitable for the upright vacuum cleaner, and others are preferably used with the handheld one.

#### Jalisco brush

Assemble this brush to the upright vacuum cleaner. This brush is especially designed for cleaning hard floors, but can be used to efficiently clean soft floors too.

#### 2-in-1 narrow accessory for corners and furniture

Fig. 4

This accessory is preferably used with the handheld vacuum cleaner and allows cleaning furniture without damaging it and reaching less accessible dirt in corners.

#### 2-in-1 wide accessory for corners and furniture

Fig. 5

This accessory is preferably used with the handheld vacuum cleaner and allows cleaning furniture without damaging it and reaching less accessible dirt in corners.

#### Long brush

Fig. 6-7

Suitable for cleaning surfaces which are sensible to scratches such as furniture, wardrobes, etc.

#### Motorised brush for upholstery

Fig. 8

This accessory is used with the handheld vacuum cleaner for an intense cleaning of upholstered furniture.

#### Special brush for fabrics

Adjustable accessory to remove all types of dust trapped in fabrics.

#### Flexible vacuuming tube

Use the Flex tube to reach and vacuum dirt from the most inaccessible areas. Press the Flex button to bend the tube.

#### Extensible tube

Use the accessory with the handheld vacuum cleaner to reach and vacuum dirt from the most inaccessible areas. Moreover, you can connect the 2-in-1 narrow and wide accessories for furniture and corners and the extension brush.

### Union elbow

Fig. 9

Suitable for dusting high cupboards, roofs, windows, corners, etc. Moreover, you can connect the 2-in-1 narrow and wide accessories for furniture and corners and the extension brush.

### Watertank accessory

With this accessory you will mop and scrub your floor just by attaching it to the vacuum cleaner.

### Wall charging base installation

Fig. 10

1. Place the charging base on the wall and mark 3 spots to be drilled to fix the base. You must take into account the height of the installation; it is important that vacuuming brush head rests on the floor to avoid the charging base from holding all the vacuum cleaner's weight.
2. Drill the 3 holes (previously marked) and insert the pegs and M4 x 32 mm screws.
3. Make sure that the charging base is securely fixed on the wall and place the vacuum cleaner on the charging base by placing the vacuum cleaner's charging terminals over the charging base's charging terminals (plastic tab).
4. Once the wall charging base is installed, connect the power adapter to the charging port, and then you can charge the vacuum cleaner by simply sliding it up and down the wall charging base. Fig. 11

### Charge and display

- When the battery percentage is 20% or below, the device will automatically enter low consumption mode. It is recommended to charge the vacuum cleaner when it reaches this percentage.
- The battery must be charged with the charging base while it is connected to the main body. Connect one of the ends of the power adapter to the power supply and the other to the charging base. Fig. 11
- During charging, the charge light indicator will turn on red and the display will show the current charge percentage. When the device is fully charged, the battery indicator will turn green, and the display will show 100 %. Fig. 12
- You can also charge the battery without using the charging base. You can charge the battery when the battery is installed or not in the vacuum cleaner. Connect the adapter and connect the other end to the battery, paying attention to the direction. Once it is properly connected, the charge light indicator will turn on red and will turn green once the charge is complete. Fig. 13

## 5. WATERTANK ACCESSORY

- Do not use cleaning agents. Use clean and room temperature water only. Do not use the vacuum cleaner to vacuum water.
- When the vacuum cleaner is not going to be used for a long period of time, remove the water tank and empty the remaining water. Do not expose it to direct sunlight or to damp environments.

### Mop installation

- Place the mop cloth on the ground with the Velcro facing upwards.
- Align the mop cloth with the Velcro strips on the water tank and attach it without covering the wheels. Fig. 14

### Replacing the mop

- Remove the water tank from the vacuum cleaner.
- Use your foot to hold the accessory against the ground and pull the vacuum cleaner upwards until both parts are separated.
- Replace the mop and refill the water tank.
- Install the water tank again, insert the tank in the lower part of the vacuuming brush head, and press until it is fixed.

### Water emission

- When using this product for the first time, make sure the water tank lid is not fully open.
- When the product is not in use, check that the water release button and cap are closed, as the product may continue to let out water if the water tank is full.
- To activate the water emission, the water emission push button must be pressed, and to stop the water emission, the push button must be in the original position, as shown in figure 15.

## 6. CLEANING AND MAINTENANCE

- Turn the appliance off, unplug it from the power socket, and allow it to cool down before cleaning it.
- Use a soft, slightly dampened cloth to clean the device's surface.
- Never immerse the device in water or other liquids. Do not allow liquids to enter the device.
- Do not use sponges, powder products, or abrasive cleaning agents to clean the product.
- Do not leave the vacuum cleaner in a place with direct sunlight.
- Do not leave the vacuum cleaner in a wet place after cleaning it.
- After the brush has been used for a long time, bristles might start to tangle with hair and other particles. Clean it for it to operate correctly again.

### Filters and tank cleaning

- To prevent the appliance from overheating and losing suction power, it is suggested to clean the filters frequently. To make the most of the suction power, it is suggested to clean the filter after every use.
- The filters shelf life will depend on the accumulated use and the type of particles which are frequently vacuumed. It is recommended to replace the filters every 6 months.
- To remove the filters (Fig. 16):
  1. Press the dust-tank opening button, marked with the word "CLEAN", and pull on the metallic handle to remove the filtering system.
  2. Once the filtering system is out, turn the metallic handle anticlockwise and you will be able to take the high-efficiency filters out.
- Vacuum and shake the filters to remove every particle and dust remain that may block them and difficult the correct air circulation. Remember not to use the vacuum cleaner without the filters properly assembled.
- Filters cannot be washed inside a washing machine nor dried with a hair dryer.
- Do not brush the high-efficiency filter.
- To empty the dust tank, press the dust tank lower-cover opening button, open it and empty it. Fig. 17

### Cleaning the Jalisco brush

Fig. 18

- Move the rotary brush release button with the finger toward the arrow and remove the cover on the same side of the brush.
- Take one end of the brush out as shown on the image.
- It is important to clear and clean all the residues left in the brush rotary axis.
- If you decide to wash the brush, you must air dry all the pieces. Assemble the pieces back to use the brush again.

### Watertank cleaning

- To clean the water tank, fill it with clean water, shake it, and empty it.
- The mop is washable; therefore, it is suggested to wash it after every use.
- Replace the cloth after 20-30 uses, depending on the use.
- When the mop cloth is used for a long time, it is possible that the water output is affected. This can be avoided by cleaning both the mop and water tank regularly.

### How to remove the battery

Press the battery release button and remove the battery as shown in figure 19. Store the battery in a plastic bag and leave it in a dry place.

### Vacuum cleaner storage

If the robot will not be used for a long period of time, remove the battery from the product, and store it in a dry and safe place.

### Maintenance indicator

The full tank icon or the clogged filter icon will be displayed if maintenance on the vacuum cleaner has not been properly and frequently carried out. Fig. 20

## 7. MOBILE APP

1. Download the CECOTEC app.
2. You must register with your email address; insert the activation code you will receive in your email address and create a password. If you already have a user account, you can log in directly.
3. Press '+' on the main display to add a new device and select the Vacuuming section, where you will find the Conga RockStar.
4. Activate the Bluetooth and search your device in the linking list.

## 8. TROUBLESHOOTING

Problem	Possible cause	Solution
The motor does not operate.	The battery does not work any longer. The metallic tubes, floor brushes, batteries or the device itself are not properly assembled.	Charge the vacuum cleaner. Make sure all parts of the vacuum cleaner are correctly assembled.
The suction power decreased, and the vacuum cleaner makes a lot of noise.	The dust tank is full. Fig. 20 The filter has too much dust. Fig. 22 The electric rotary brush inlet is obstructed, or the brush is blocked. Fig. 21	Clean the dirt. Clean or replace the filter. Clean the dust inside the electric rotary brush.
Insufficient operating time after charging the vacuum cleaner. (The battery life may vary according to the room temperature).	Insufficient charge time. The battery is old.	Fully charge the battery following the instructions in this manual. Batteries are easily recycled. Go to the closest maintenance point and buy new batteries.

## 9. ERROR CODES

Code	Problem	Cause
E1	The vacuum cleaner shuts down and does not charge.	Short circuit
E2	The vacuum cleaner does not charge.	The charger's voltage is below 36.3 V
E2	The vacuum cleaner does not charge.	The charger's voltage is below 32.1 V
	The vacuum cleaner shuts down.	Low battery
E3	The device turns off and displays E3	The motor short-circuits when the battery is low
E5	The device turns off and displays E5	Main motor overload (second level)
E6	The device turns off and displays E6	Main motor overload
E9	The device turns off and displays E9	Temperature too high or low
E7	The device stops working or does not turn on and shows E7	Battery fault (first level)
E8	The device turns off and displays E8	NTC error (thermistor short circuit)
High-efficiency filter indicator blinks	The device stops working or does not turn on. Fig. 22	High-efficiency filter not installed
The filter icon flashes	It works normally. Fig. 20	The dust tank or the inlet filter is blocked
The brush icon flashes	The long brush and motor stop working. Fig. 21	Blocked long brush Long brush full of hair

## 10. TECHNICAL SPECIFICATIONS

Product reference: 09942

Product: Conga Rockstar 9500 Connected Ergowet 3000 IA

Voltage and frequency: 100-240 V ~ 50/60 Hz

29.6 V DC 3000 mAh 88.8 Wh battery

Motor rated power: 630 W

Brush rated power: 50 W

Charger output: 34.2 V DC 0.6 A

Technical specifications may change without prior notification to improve product quality.

Made in China | Designed in Spain

## 11. DISPOSAL OF OLD ELECTRICAL AND ELECTRONIC APPLIANCES



This symbol indicates that, according to the applicable regulations, the product and/or battery must be disposed of separately from household waste. When this product reaches the end of its shelf life, you should dispose of the batteries/accumulators and take them to a collection point designated by the local authorities.

For detailed information on the most appropriate way to dispose of electrical and electronic equipment and/or batteries, consumers should contact their local authorities.

Compliance with the above guidelines will help protecting the environment.

## 12. TECHNICAL SUPPORT AND WARRANTY

Cecotec shall be liable to the end user or consumer for any lack of conformity that exists at the time of delivery of the product under the terms, conditions, and deadlines established by the applicable regulations.

It is recommended that repairs be carried out by qualified personnel.

If at any moment you detect any problem with your product or have any doubt, do not hesitate to contact Cecotec official Technical Support Service at +34 963 210 728.

## 13. COPYRIGHT

The intellectual property rights over the texts in this manual belong to CECOTEC INNOVACIONES, S.L. All rights reserved. The contents of this publication may not, in whole or in part, be reproduced, stored in a retrieval system, transmitted, or distributed by any means (electronic, mechanical, photocopying, recording or similar) without the prior authorization of CECOTEC INNOVACIONES, S.L.

## 14. DECLARATION OF CONFORMITY

Cecotec Innovaciones hereby declares this upright vacuum cleaner, model 09942 Conga Rockstar 9500 Connected Ergowet 3000 IA complies with the Directive 2014/53/EU on radio equipment.

The full text of the EU Declaration of Conformity can be found on the following website: [www.cecotec.es](http://www.cecotec.es)

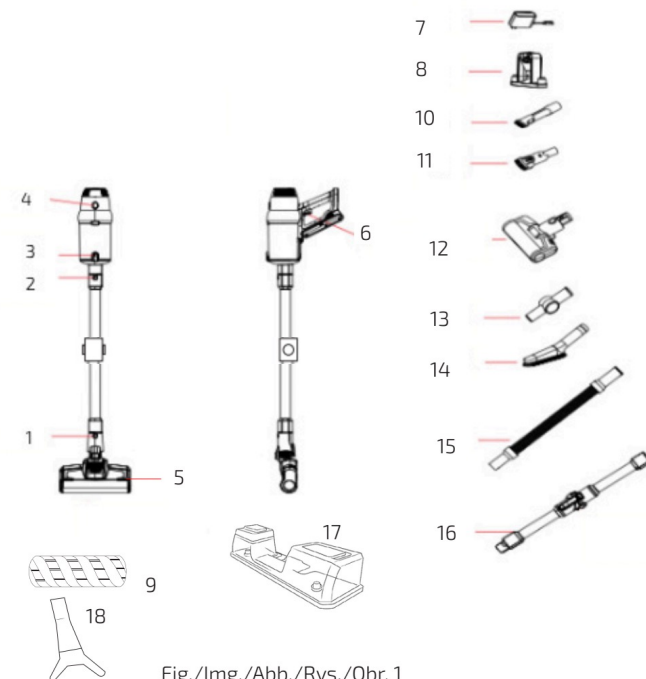

Fig./Img./Abb./Rys./Obr. 1

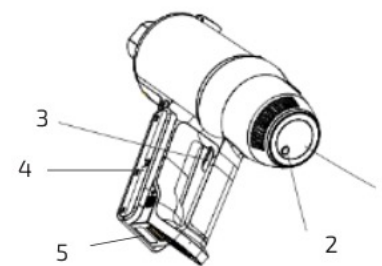

Fig./Img./Abb./Afb./ Rys./Obr. 2

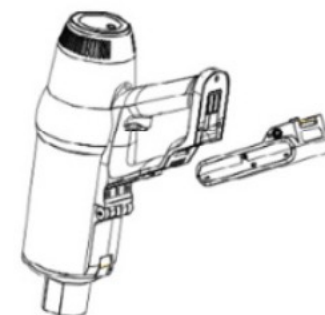

Fig./Img./Abb./Afb./ Rys./Obr. 3



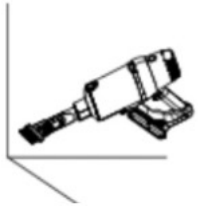

Fig./Img./Abb./Afb./ Rys./Obr. 4



Fig./Img./Abb./Afb./ Rys./Obr. 5

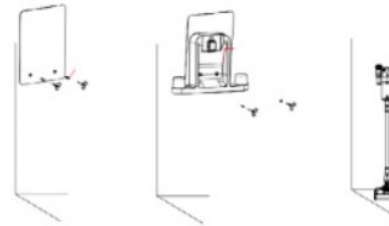

Fig./Img./Abb./Afb./ Rys./Obr. 10

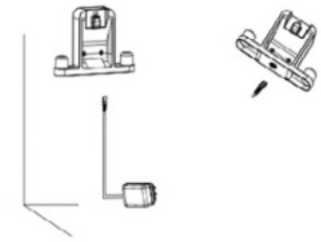

Fig./Img./Abb./Afb./ Rys./Obr. 11



Fig./Img./Abb./Afb./ Rys./Obr. 6



Fig./Img./Abb./Afb./ Rys./Obr. 7



Fig./Img./Abb./Afb./ Rys./Obr. 12

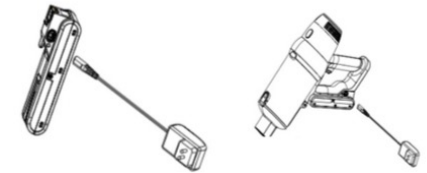

Fig./Img./Abb./Afb./ Rys./Obr. 13

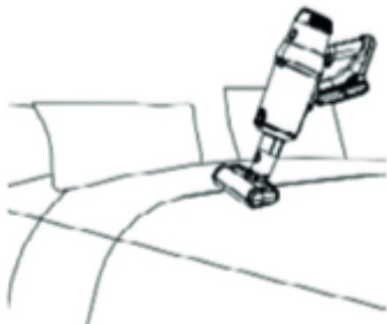

Fig./Img./Abb./Afb./ Rys./Obr. 8



Fig./Img./Abb./Afb./ Rys./Obr. 9

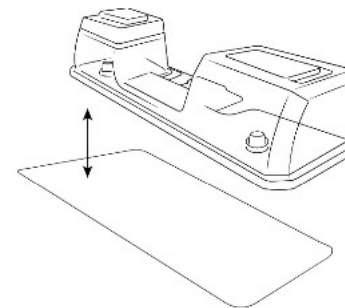

Fig./Img./Abb./Afb./ Rys./Obr. 14

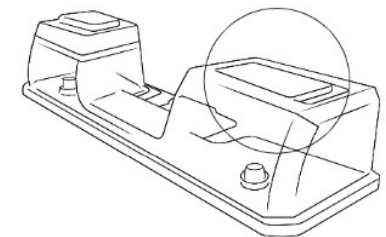

Fig./Img./Abb./Afb./ Rys./Obr. 15

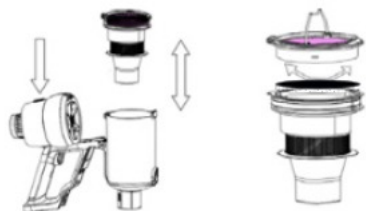

Fig./Img./Abb./Afb./ Rys./Obr. 16

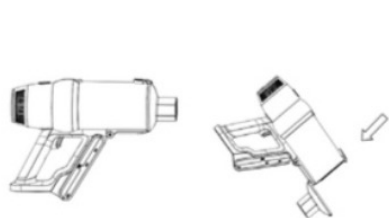

Fig./Img./Abb./Afb./ Rys./Obr. 17

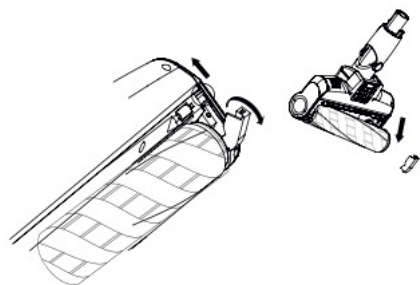

Fig./Img./Abb./Afb./ Rys./Obr. 18

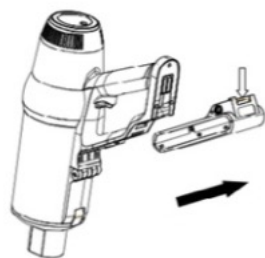

Fig./Img./Abb./Afb./ Rys./Obr. 19



Fig./Img./Abb./Afb./  
Rys./Obr. 20



Fig./Img./Abb./Afb./  
Rys./Obr. 21



Fig./Img./Abb./Afb./  
Rys./Obr. 22

[www.cecotec.es](http://www.cecotec.es)

Cecotec Innovaciones S. L.  
C/de la Pinadeta s/n, 46930  
Quart de Poblet, Valencia, Spain

EA01220620